



Licensing Sub-Committee Thursday, 18th July, 2013

You are invited to attend the next meeting of **Licensing Sub-Committee**, which will be held at:

**Council Chamber, Civic Offices, High Street, Epping
on Thursday, 18th July, 2013
at 6.30 pm .**

**Glen Chipp
Chief Executive**

**Democratic Services
Officer**

Gary Woodhall
Office of the Chief Executive
Direct Line 01992 564470
Email: democraticservices@eppingforestdc.gov.uk

Members:

Councillors R Morgan (Chairman), H Mann and A Mitchell MBE

<p>PLEASE NOTE THE START TIME OF THE MEETING</p>

1. APOLOGIES FOR ABSENCE

(Assistant to the Chief Executive) To be announced at the meeting.

2. DECLARATIONS OF INTEREST

(Assistant to the Chief Executive) To declare interests in any item on this agenda.

3. PROCEDURE FOR THE CONDUCT OF BUSINESS (Pages 5 - 10)

(Assistant to the Chief Executive) For all participants to note the agreed procedure for the conduct of business.

4. PREMISES LICENCE - 295 HIGH ROAD, LOUGHTON IG10 1AL (Pages 11 - 46)

(Director of Corporate Support Services) To consider the attached report.

5. SEX ESTABLISHMENT LICENCE - UNIT 11G, CHASE FARM, VICARAGE LANE, NORTH WEALD CM16 6AL (Pages 47 - 62)

(Director of Corporate Support Services) To consider the attached report.

6. EXCLUSION OF PUBLIC AND PRESS

Exclusion

To consider whether, under Section 100(A)(4) of the Local Government Act 1972, the public and press should be excluded from the meeting for the items of business set out below on grounds that they will involve the likely disclosure of exempt information as defined in the following paragraph(s) of Part 1 of Schedule 12A of the Act (as amended) or are confidential under Section 100(A)(2):

Agenda Item No	Subject	Exempt Information Paragraph Number
Nil	Nil	Nil

The Local Government (Access to Information) (Variation) Order 2006, which came into effect on 1 March 2006, requires the Council to consider whether maintaining the exemption listed above outweighs the potential public interest in disclosing the information. Any member who considers that this test should be applied to any currently exempted matter on this agenda should contact the proper officer at least 24 hours prior to the meeting.

Confidential Items Commencement

Paragraph 9 of the Council Procedure Rules contained in the Constitution require:

- (1) All business of the Council requiring to be transacted in the presence of the press and public to be completed by 10.00 p.m. at the latest.
- (2) At the time appointed under (1) above, the Chairman shall permit the completion of debate on any item still under consideration, and at his or her discretion, any other remaining business whereupon the Council shall proceed to exclude the public and press.
- (3) Any public business remaining to be dealt with shall be deferred until after the completion of the private part of the meeting, including items submitted for report rather than decision.

Background Papers

Paragraph 8 of the Access to Information Procedure Rules of the Constitution define background papers as being documents relating to the subject matter of the report which in the Proper Officer's opinion:

- (a) disclose any facts or matters on which the report or an important part of the report is based; and
- (b) have been relied on to a material extent in preparing the report and does not include published works or those which disclose exempt or confidential information (as defined in Rule 10) and in respect of executive reports, the advice of any political advisor.

Inspection of background papers may be arranged by contacting the officer responsible for the item.

This page is intentionally left blank

Agenda Item 3

PART 3(2) - RESPONSIBILITY FOR COUNCIL FUNCTIONS

LICENSING COMMITTEE – TERMS OF REFERENCE

(1) The full Committee shall comprise 11 Councillors appointed by the Council at its annual meeting, including a Chairman and Vice-Chairman.

... (2) For the functions set out in Annex 1, and the legislation listed in Annex 2, a Sub-Committee consisting of no more than any three Councillors drawn, in alphabetical order, from the members of the full Committee shall be formed. Any such Sub-Committee shall elect a Chairman on an ad-hoc basis.

(3) For the transaction of business at full Committee meetings, the quorum shall be a minimum of five Committee members save that no business shall be transacted unless either the Chairman or Vice-Chairman of the Committee is present.

(4) The Committee and Sub-Committees shall have full authority to hear and determine licensing applications.

(5) The Committee and Sub-Committees shall be further empowered to determine appeals made against the decisions of the Head of Environmental Services taken under delegated authority on licensing applications.

... (6) The Committee shall at all times carry out its duties solely within the policy from time to time determined by the Council and shall conduct its proceedings in accordance with the requirements set out in Annex 3 (Conduct of Business by Licensing Committee and Sub-Committees).

(7) The Licensing Committee shall take no part in the production or revision of the statement of licensing policy made under Section 5 of the Licensing Act 2003, however, they may determine policy under the legislation listed in Annex 3.

**PART 3(2) – RESPONSIBILITY
FOR FUNCTIONS
LICENSING COMMITTEE**

Licensing Act 2003 – LIST OF FUNCTIONS AND DELEGATED AUTHORITY

Matter to be dealt with	Full Committee	Sub Committee	Officers
Application for personal licence		If a police objection	If no objection made
Application for personal licence with unspent convictions		All cases	
Application for premises licence/club premises certificate		If a relevant representation made	If no relevant representation made
Application for provisional statement		If a relevant representation made	If no relevant representation made
Application to vary premises licence/club premises certificate		If a relevant representation made	If no relevant representation made
Application to vary designated premises supervisor		If a police objection	All other cases
Request to be removed as designated premises supervisor			All cases
Application for transfer of premises licence		If a police objection	All other cases
Applications for interim Authorities		If a police objection	All other cases
Application to review premises licence/club premises certificate		All cases	
Decision on whether a complaint is irrelevant frivolous vexatious etc			All cases
Decision to object when local authority is a consultee and not the relevant authority considering the application		All cases	
Determination of a police objection to a temporary event notice		All cases	
All policy matters except the formulation of the statement of licensing policy	All cases		

**PART 3(2) – RESPONSIBILITY
FOR FUNCTIONS
LICENSING COMMITTEE**

LIST OF STATUTORY POWERS

Those functions pertaining to licensing and registration and permits and consents contained in the following legislation and any regulations, orders, byelaws or other subsidiary legislation made under the above Acts:

Animal Boarding Establishments Act 1963
Breeding & Sale of Dogs (Welfare) Act 1999
Breeding of Dogs Act 1973
Breeding of Dogs Act 1991
Caravan Sites & Control of Development Act 1960
Caravan Sites Act 1968
Dangerous Wild Animals Act 1976
Game Licences Act 1860
Gaming Act 1968
Guard Dogs Act 1975
House to House Collections Act 1939
Licensing Act 2003
Local Government (Miscellaneous Provisions) Act 1976
Local Government (Miscellaneous Provisions) Act 1982
Lotteries & Amusements Act 1976
Pet Animals Acts 1951 & 1981
Riding Establishments Acts 1964 & 1970
Scrap Metal Dealers Act 1964
The Game Act 1831
Town Police Clauses Act 1847
Town Police Clauses Act 1889
Zoo Licensing Act 1981

Part 3(2) – Responsibility for Functions

PART A – CONDUCT OF BUSINESS BY LICENSING COMMITTEE AND SUB-COMMITTEES

All references to committee in this annex shall be taken to infer a reference to the associated sub-committees.

1. General Conduct

- 1.1 All hearings of the Licensing Committee under the Licensing Act 2003, are to be held in accordance with the Personal Licences, Hearings, Premises Licences and Club Premises Certificates, and Licensing Register Regulations, made under the Licensing Act 2003.
- 1.2 The Council's Constitution shall regulate the conduct of and debate at meetings.
- 1.3 In the case of hearings under the Licensing Act 2003, the Committee shall only consider those matters relevant to the licensing objectives as set out in the Licensing Act 2003 and the statement of licensing policy adopted by the Council.

2. Declarations of Interest

- 2.1 Members of the Committee are subject to the Council's Code of Conduct and to advice from the Standard Board for England, details of which will be provided to those members.

3. Participation in the Hearing

- 3.1 Debate shall be restricted to members of the Licensing Committee. Where a local ward member, not being a member of the Committee, wishes to participate in the hearing, they may do so only with the permission of the Chairman and their participation shall be subject to the same rules as are applied to any other witnesses to the application.
- 3.2 In hearings other than those under the Licensing Act 2003, where a ward member is a member of the Committee, and wishes to object to the application, the member shall give 14 days' notice of their intention, and shall play no part in the decision-making process of the Committee. In hearings under the Licensing Act 2003, those named as responsible authorities and interested parties in the Act may only make representations within the time limits set out in the relevant statutory provisions.
- 3.3 All persons participating in the hearing shall be made aware of the limitations or scope of statements that will be acceptable and, in particular, that statements should be factual or a fair statement on a matter of public interest.

4. Attendance of the Public

- 4.1 The Council's Constitution and relevant statutory provisions relating to the admission or exclusion of the public shall apply to all meetings of the Licensing Committee.

5. Natural Justice

5.1 There are two elements to natural justice:

(a) Fairness

- (i) All persons affected by the decision or in the case of matters associated with the Licensing Act 2003, those named as responsible authorities and interested parties in the Act, will be allowed a hearing before a decision is made.
- (ii) Only objectors who can show clearly that they are affected by a decision shall be afforded the right to be heard or, in the case of hearings under the Licensing Act 2003, only those named in the Act as responsible authorities or interested parties.
- (iii) All information shall be made available, where possible in advance, to the applicant and the Committee.
- (iv) All members of the Committee shall be present throughout the hearing of a particular application. Where a member arrives late or leaves during a hearing of a particular application, that member shall play no part in the decision-making process. Where an application is adjourned it shall be continued by the same members only, and no others.
- (v) The Committee shall have discretion in respect of 'late' objections. Such objections shall be clearly marked on the agenda as such and the Committee shall decide on their acceptability. The applicant shall be advised of any late objections. In the case of representations made in relation to the Licensing Act 2003 applications, these shall only be accepted in accordance with the relevant statutory provisions.

(b) Prevention of Bias

- (i) The rules on the declarations of interest shall be firmly applied.
- (ii) If the Committee moves into private session to consider its decision, it shall be accompanied only by its advising officers, none of whom shall have taken a substantive part in the hearing, and shall play no substantive part in the decision-making process.

6. General Procedures for Hearings

6.1 The following procedural requirements shall be followed at all times:

- (a) There shall be no recommendation from officers on the agenda;
- (b) The Committee shall be supplied with copies of all relevant documentation and the process and order of procedure shall be as follows:
 - (i) The Chairman will open the meeting and introduce persons as appropriate asking applicants and representatives to identify themselves.
 - (ii) The Chairman will outline the procedure to be followed.

- (iii) The Lead Officer will outline the matter in hand.
- (iv) The applicant or representative will present his/her case, with or without witnesses, and be questioned by members or any objectors/persons making representations present.
- (v) Any objectors/persons making representations may then present their objections/representation, with or without witnesses, and be questioned by members or the applicant/s or their representative.
- (vi) The objectors/persons making representations may make a final statement (without introducing new issues).
- (vii) Finally, the applicant has the right to make a final statement (without introducing new issues).
- (viii) All evidence/disclosures are to be made in the presence of all persons, unless someone voluntarily excuses themselves from the proceedings.
- (ix) Committee members shall restrict themselves to questions and not discussion or comment.
- (x) The applicant, objectors/persons making representations shall be allowed to ask officers questions of a technical/factual nature at any time during the proceedings.
- (xi) An adjournment should be granted where to do otherwise would deny a fair hearing.
- (xii) The Committee may resolve to decide upon the application in private session, however, if it becomes necessary to recall anyone for additional information, everyone shall be invited to return to the Hearing.
- (xiii) The decision shall be given in the presence of all parties that wish to be present and confirmed in writing as soon as possible thereafter. If legal advice is given to members this advice will be repeated in summary form.



Report to the Licensing Sub Committee

Date of meeting: 18 July 2013

**Subject: Premises Licence - 295 High Road, Loughton,
Essex IG10 1AL**

Responsible Officer: Kim Tuckey 01992 564034

Democratic Services: Gary Woodhall 01992 564470

Decisions Required:

(1) To determine the application for a Premises Licence under the Licensing Act 2003.

Report:

Application

1. An application has been made by Nurcan Coskun for a premises licence for the above premises. The application was received on the 30 May 2013 and is attached to this report. The application sets out the relevant licensing activities applied for and times requested.

2. The Operating Schedule sets out conditions which will be attached to the licence if this application is granted.

Licensing Act 2003

3. When considering an application for a licence the licensing authority must have regard to steps that are appropriate to promote of the licensing objectives. These are:

- (a) the prevention of crime and disorder;
- (b) public safety;
- (c) the prevention of public nuisance; and
- (d) the protection of children from harm.

4. It must also have regard to its Statement of Licensing Policy and any guidance issued by the Secretary of State.

Consultation

5. The Responsible Authorities have received a copy of the application; it was properly advertised at the premises and in a local newspaper

6. The authority has received a representation from Essex Police; however they retracted their objection after negotiation with the applicant to amend the hours.

7. Three objections were received from local residents on the grounds of public nuisance and Crime & Disorder

Guidance Issued by the Secretary of State

8. The Licensing Act 2003 provides that the licensing authority must 'have regard to'

guidance issued by the Secretary of State under section 182.

9. Sections 2.12.7 & 2.18 to 2.24 of the amended Guidance are relevant to this application.

Options

10. In determining this application the Sub-Committee may take any of the following steps as it considers necessary for the promotion of the licensing objectives, namely:

- (a) to grant the licence as applied for subject to:
 - (i) the conditions mentioned in the Operating Schedule modified as the Sub-Committee considers necessary for the promotion of the licensing objectives; and
 - (ii) the mandatory conditions specified in the Licensing Act 2003;
- (b) to exclude from the scope of the licence any licensable activities to which the application relates;
- (c) refuse to specify a person as the premises supervisor; or
- (d) reject the application.

Determination

11. The Sub-Committee is asked to determine the application having regard to:

- (a) the content of this report and representations;
- (b) any additional information obtained from the hearing;
- (c) the Council's statement of licensing policy;
- (d) Guidance issued by the Secretary of State; and
- (e) the steps appropriate to promote the licensing objectives.

Appeal

12. If any party is aggrieved with the decision they can appeal to Magistrates court. The appeal period is 21 days from notification of the decision.

Background Papers Used In Preparing This Report:

- The Licensing Act 2003
<http://www.legislation.gov.uk/ukpga/2003/17/contents?view=plain>
- The Secretary of State's Guidance issued under Section 182 Licensing Act 2003
- Epping Forest District Council's statement of licensing policy.
<http://www.eppingforestdc.gov.uk>

Attached documents

- Application for premises licence and public notice
- Representation from Essex Police & email of agreement with Essex Police and the applicants agent
- Loughton Town councils letter
- Three objections from local residents
- Map showing the area

This page is intentionally left blank

**Application for a premises licence to be granted
under the Licensing Act 2003**

PLEASE READ THE FOLLOWING INSTRUCTIONS FIRST

Before completing this form please read the guidance notes at the end of the form.
If you are completing this form by hand please write legibly in block capitals. In all cases ensure that your answers are inside the boxes and written in black ink. Use additional sheets if necessary.

You may wish to keep a copy of the completed form for your records.

I/We **NURCAN COSKUN**

(Insert name(s) of applicant)

apply for a premises licence under section 17 of the Licensing Act 2003 for the premises described in Part 1 below (the premises) and I/we are making this application to you as the relevant licensing authority in accordance with section 12 of the Licensing Act 2003

Part 1 – Premises Details

Postal address of premises or, if none, ordnance survey map reference or description			
295 HIGH ROAD			
LOUGHTON			
Post town	ESSEX	Post code	IG10 1AL

Telephone number at premises (if any)	
Non-domestic rateable value of premises	£29750

Part 2 - Applicant Details

Please state whether you are applying for a premises licence as
Please tick yes

- a) an individual or individuals * please complete section (A)
- b) a person other than an individual *
 - i. as a limited company please complete section (B)
 - ii. as a partnership please complete section (B)
 - iii. as an unincorporated association or please complete section (B)
 - iv. other (for example a statutory corporation) please complete section (B)
- c) a recognised club please complete section (B)
- d) a charity please complete section (B)

- e) the proprietor of an educational establishment please complete section (B)
- f) a health service body please complete section (B)
- g) a person who is registered under Part 2 of the Care Standards Act 2000 (c14) in respect of an independent hospital please complete section (B)
- h) the chief officer of police of a police force in England and Wales please complete section (B)

* If you are applying as a person described in (a) or (b) please confirm:

Please tick yes

- I am carrying on or proposing to carry on a business which involves the use of the premises for licensable activities; or
- I am making the application pursuant to a
 - statutory function or
 - a function discharged by virtue of Her Majesty's prerogative

(A) INDIVIDUAL APPLICANTS (fill in as applicable)

Mr <input type="checkbox"/>	Mrs <input checked="" type="checkbox"/>	Miss <input type="checkbox"/>	Ms <input type="checkbox"/>	Other Title (for example, Rev)	
Surname COSKUN			First names NURCAN		
I am 18 years old or over				<input checked="" type="checkbox"/> Please tick yes	
Current postal address if different from premises address		HAMPTON ROAD CHINGFORD			
Post Town	LONDON			Postcode	
Daytime contact telephone number					
E-mail address (optional)					

SECOND INDIVIDUAL APPLICANT (if applicable)

Mr <input type="checkbox"/>	Mrs <input type="checkbox"/>	Miss <input type="checkbox"/>	Ms <input type="checkbox"/>	Other Title (for example, Rev)	
Surname			First names		
I am 18 years old or over				<input type="checkbox"/> Please tick yes	

Current postal address if different from premises address			
Post Town		Postcode	
Daytime contact telephone number			
E-mail address (optional)			

(B) OTHER APPLICANTS

Please provide name and registered address of applicant in full. Where appropriate please give any registered number. In the case of a partnership or other joint venture (other than a body corporate), please give the name and address of each party concerned.

Name
Address
Registered number (where applicable)
Description of applicant (for example, partnership, company, unincorporated association etc.)
Telephone number (if any)
E-mail address (optional)

Part 3 Operating Schedule

When do you want the premises licence to start?

Day		Month		Year	
2	1	8	0	6	2
1	1	1	3		

If you wish the licence to be valid only for a limited period, when do you want it to end?

Day		Month		Year	

Please give a general description of the premises (please read guidance note 1)
CONVENIENCE STORE
OFF LICENCE, GROCERIES & NEWSPAPERS

If 5,000 or more people are expected to attend the premises at any one time, please state the number expected to attend.

What licensable activities do you intend to carry on from the premises?

(Please see sections 1 and 14 of the Licensing Act 2003 and Schedules 1 and 2 to the Licensing Act 2003)

Provision of regulated entertainment

Please tick yes

- a) plays (if ticking yes, fill in box A)
- b) films (if ticking yes, fill in box B)
- c) indoor sporting events (if ticking yes, fill in box C)
- d) boxing or wrestling entertainment (if ticking yes, fill in box D)
- e) live music (if ticking yes, fill in box E)
- f) recorded music (if ticking yes, fill in box F)
- g) performances of dance (if ticking yes, fill in box G)
- h) anything of a similar description to that falling within (e), (f) or (g) (if ticking yes, fill in box H)

Provision of entertainment facilities:

- i) making music (if ticking yes, fill in box I)
- j) dancing (if ticking yes, fill in box J)
- k) entertainment of a similar description to that falling within (i) or (j) (if ticking yes, fill in box K)

Provision of late night refreshment (if ticking yes, fill in box L)

Supply of alcohol (if ticking yes, fill in box M)

In all cases complete boxes N, O and P

A

Plays Standard days and timings (please read guidance note 6)			Will the performance of a play take place indoors or outdoors or both – please tick (please read guidance note 2)	Indoors	<input type="checkbox"/>
Day	Start	Finish		Outdoors	<input type="checkbox"/>
Mon			Please give further details here (please read guidance note 3)	Both	<input type="checkbox"/>
Tue					
Wed			State any seasonal variations for performing plays (please read guidance note 4).		
Thur					
Fri			Non standard timings. Where you intend to use the premises for the performance of plays at different times to those listed in the column on the left, please list (please read guidance note 5)		
Sat					
Sun					

B

Films Standard days and timings (please read guidance note 6)			Will the exhibition of films take place indoors or outdoors or both – please tick (please read guidance note 2)	Indoors	<input type="checkbox"/>
				Outdoors	<input type="checkbox"/>
				Both	<input type="checkbox"/>
Day	Start	Finish			
Mon			Please give further details here (please read guidance note 3)		
Tue					
Wed			State any seasonal variations for the exhibition of films (please read guidance note 4)		
Thur					
Fri			Non standard timings. Where you intend to use the premises for the exhibition of films at different times to those listed in the column on the left, please list (please read guidance note 5)		
Sat					
Sun					

C

Indoor sporting events Standard days and timings (please read guidance note 6)			<u>Please give further details</u> (please read guidance note 3)
Day	Start	Finish	
Mon			
Tue			<u>State any seasonal variations for indoor sporting events</u> (please read guidance note 4)
Wed			
Thur			<u>Non standard timings. Where you intend to use the premises for indoor sporting events at different times to those listed in the column on the left, please list</u> (please read guidance note 5)
Fri			
Sat			
Sun			

D

Boxing or wrestling entertainments Standard days and timings (please read guidance note 6)			Will the boxing or wrestling entertainment take place indoors or outdoors or both – please tick (please read guidance note 2)	Indoors	<input type="checkbox"/>
				Outdoors	<input type="checkbox"/>
				Both	<input type="checkbox"/>
Day	Start	Finish	Please give further details here (please read guidance note 3)		
Mon					
Tue					
Wed			State any seasonal variations for boxing or wrestling entertainment (please read guidance note 4)		
Thur					
Fri					
Sat			Non standard timings. Where you intend to use the premises for boxing or wrestling entertainment at different times to those listed in the column on the left, please list (please read guidance note 5)		
Sun					

E

Live music Standard days and timings (please read guidance note 6)			Will the performance of live music take place indoors or outdoors or both – please tick (please read guidance note 2)	Indoors	<input type="checkbox"/>
				Outdoors	<input type="checkbox"/>
				Both	<input type="checkbox"/>
Day	Start	Finish	Please give further details here (please read guidance note 3)		
Mon					
Tue					
Wed			State any seasonal variations for the performance of live music (please read guidance note 4)		
Thur					
Fri					
Sat			Non standard timings. Where you intend to use the premises for the performance of live music at different times to those listed in the column on the left, please list (please read guidance note 5)		
Sun					

F

Recorded music Standard days and timings (please read guidance note 6)			Will the playing of recorded music take place <u>indoors or outdoors or both – please tick</u> (please read guidance note 2)	Indoors	<input type="checkbox"/>
Day	Start	Finish		Outdoors	<input type="checkbox"/>
Mon			Please give further details here (please read guidance note 3)	Both	<input type="checkbox"/>
Tue					
Wed			State any seasonal variations for the playing of recorded music (please read guidance note 4)		
Thur					
Fri			Non standard timings. Where you intend to use the premises for the playing of recorded music at different times to those listed in the column on the left, please list (please read guidance note 5)		
Sat					
Sun					

G

Performances of dance Standard days and timings (please read guidance note 6)			Will the performance of dance take place indoors or outdoors or both – please tick (please read guidance note 2)	Indoors	<input type="checkbox"/>
				Outdoors	<input type="checkbox"/>
				Both	<input type="checkbox"/>
Day	Start	Finish	Please give further details here (please read guidance note 3)		
Mon					
Tue			State any seasonal variations for the performance of dance (please read guidance note 4)		
Wed					
Thur			Non standard timings. Where you intend to use the premises for the performance of dance at different times to those listed in the column on the left, please list (please read guidance note 5)		
Fri					
Sat					
Sun					

H

<p>Anything of a similar description to that falling within (e), (f) or (g) Standard days and timings (please read guidance note 6)</p>			<p><u>Please give a description of the type of entertainment you will be providing</u></p>		
Day	Start	Finish	<p><u>Will this entertainment take place indoors or outdoors or both – please tick</u> (please read guidance note 2)</p>	Indoors	<input type="checkbox"/>
Mon				Outdoors	<input type="checkbox"/>
				Both	<input type="checkbox"/>
Tue			<p><u>Please give further details here</u> (please read guidance note 3)</p>		
Wed					
Thur			<p><u>State any seasonal variations for entertainment of a similar description to that falling within (e), (f) or (g)</u> (please read guidance note 4)</p>		
Fri					
Sat			<p><u>Non standard timings. Where you intend to use the premises for the entertainment of a similar description to that falling within (e), (f) or (g) at different times to those listed in the column on the left, please list</u> (please read guidance note 5)</p>		
Sun					

Provision of facilities for making music Standard days and timings (please read guidance note 6)			<u>Please give a description of the facilities for making music you will be providing</u>	
			<u>Will the facilities for making music be indoors or outdoors or both – please tick</u> (please read guidance note 2)	
			Indoors	<input type="checkbox"/>
			Outdoors	<input type="checkbox"/>
			Both	<input type="checkbox"/>
Day	Start	Finish	<u>Please give further details here</u> (please read guidance note 3)	
Mon				
Tue			<u>State any seasonal variations for the provision of facilities for making music</u> (please read guidance note 4)	
Wed				
Thur			<u>Non-standard timings: Where you intend to use the premises for provision of facilities for making music at different times to those listed in the column on the left, please list</u> (please read guidance note 5)	
Fri				
Sat				
Sun				

J

Provision of facilities for dancing Standard days and timings (please read guidance note 6)			Will the facilities for dancing be indoors or outdoors or both – please tick (see guidance note 2)	Indoors <input type="checkbox"/>
				Outdoors <input type="checkbox"/>
				Both <input type="checkbox"/>
Day	Start	Finish	Please give a description of the facilities for dancing you will be providing	
Mon			Please give further details here (please read guidance note 3)	
Tue				
Wed			State any seasonal variations for providing dancing facilities (please read guidance note 4)	
Thur				
Fri			Non standard timings. Where you intend to use the premises for the provision of facilities for dancing entertainment at different times to those listed in the column on the left, please list (please read guidance note 5)	
Sat				
Sun				

K

Provision of facilities for entertainment of a similar description to that falling within i or j Standard days and timings (please read guidance note 6)			<u>Please give a description of the type of entertainment facility you will be providing</u>		
Day	Start	Finish	<u>Will the entertainment facility be indoors or outdoors or both – please tick</u> (please read guidance note 2)	Indoors	<input type="checkbox"/>
Mon				Outdoors	<input type="checkbox"/>
				Both	<input type="checkbox"/>
Tue			<u>Please give further details here</u> (please read guidance note 3)		
Wed					
Thur			<u>State any seasonal variations for the provision of facilities for entertainment of a similar description to that falling within i or j</u> (please read guidance note 4)		
Fri					
Sat			<u>Non standard timings. Where you intend to use the premises for the provision of facilities for entertainment of a similar description to that falling within i or j at different times to those listed in the column on the left, please list</u> (please read guidance note 5)		
Sun					

L

Late night refreshment Standard days and timings (please read guidance note 6)			Will the provision of late night refreshment take place indoors or outdoors or both – please tick (please read guidance note 2)	Indoors	<input type="checkbox"/>
				Outdoors	<input type="checkbox"/>
				Both	<input type="checkbox"/>
Day	Start	Finish	Please give further details here (please read guidance note 3)		
Mon					
Tue			State any seasonal variations for the provision of late night refreshment (please read guidance note 4)		
Wed					
Thur			Non standard timings. Where you intend to use the premises for the provision of late night refreshment at different times, to those listed in the column on the left, please list (please read guidance note 5)		
Fri					
Sat					
Sun					

M

Supply of alcohol Standard days and timings (please read guidance note 6)			Will the supply of alcohol be for consumption (Please tick box) (please read guidance note 7)	On the premises	<input type="checkbox"/>
				Off the premises	<input checked="" type="checkbox"/>
				Both	<input type="checkbox"/>
Day	Start	Finish	State any seasonal variations for the supply of alcohol (please read guidance note 4)		
Mon	07.00	01.00			
Tue	07.00	01.00			
Wed	07.00	01.00			
Thur	07.00	01.00			
Fri	07.00	01.00			
Sat	07.00	01.00			
Sun	07.00	01.00			
			Non standard timings. Where you intend to use the premises for the supply of alcohol at different times to those listed in the column on the left, please list (please read guidance note 5)		

State the name and details of the individual whom you wish to specify on the licence as premises supervisor

Name HAYDAR GULTEKIN	
Address	
Postcode	
Personal Licence number (if known)	
Issuing licensing authority (if known) WALTHAM FOREST COUNCIL	

N

Please highlight any adult entertainment or services, activities, other entertainment or matters ancillary to the use of the premises that may give rise to concern in respect of children (please read guidance note 8)

NONE

O

Hours premises are open to the public Standard days and timings (please read guidance note 6)			State any seasonal variations (please read guidance note 4)
Day	Start	Finish	
Mon	07.00	01.00	<p>Non standard timings. Where you intend the premises to be open to the public at different times from those listed in the column on the left, please list (please read guidance note 5)</p>
Tue	07.00	01.00	
Wed	07.00	01.00	
Thur	07.00	01.00	
Fri	07.00	01.00	
Sat	07.00	01.00	
Sun	07.00	01.00	

P Describe the steps you intend to take to promote the four licensing objectives:

a) General – all four licensing objectives (b,c,d,e) (please read guidance note 9)

All staff making sales of alcohol must be a Personal Licence holder or trained and authorised in writing by the Designated Premises Supervisor.

b) The prevention of crime and disorder

A digital Closed Circuit Television System will be installed and maintained on the premises. The CCTV system will be recording at all times when the premises are open and the recordings shall be kept for 31 days and made available to the police and the council on request.

c) Public safety

Fire safety equipment will be checked regularly and any requirements made by the Fire Safety Officer will be complied with.

d) The prevention of public nuisance

Signs will be displayed at the exit reminding customers to leave quietly and respect the neighbours.

e) The protection of children from harm

All staff will be trained that alcohol will only be sold to persons who can produce photographic identification where there is any doubt that they are over the age of 18.

All persons who appear to be under 25 will be challenged to produce photographic identification.

A Refusal Book will be maintained and available for inspection by the Police or the Council officers upon request.

Please tick yes

- I have made or enclosed payment of the fee
- I have enclosed the plan of the premises
- I have sent copies of this application and the plan to responsible authorities and others where applicable
- I have enclosed the consent form completed by the individual I wish to be premises supervisor, if applicable
- I understand that I must now advertise my application
- I understand that if I do not comply with the above requirements my application will be rejected

IT IS AN OFFENCE, LIABLE ON CONVICTION TO A FINE UP TO LEVEL 5 ON THE STANDARD SCALE, UNDER SECTION 158 OF THE LICENSING ACT 2003 TO MAKE A FALSE STATEMENT IN OR IN CONNECTION WITH THIS APPLICATION

Part 4 – Signatures (please read guidance note 10)

Signature of applicant or applicant's solicitor or other duly authorised agent (See guidance note 11). If signing on behalf of the applicant please state in what capacity.

Signature	
Date	28 th May 2013
Capacity	AUTHORISED AGENT

For joint applications signature of 2nd applicant or 2nd applicant's solicitor or other authorised agent. (please read guidance note 12). If signing on behalf of the applicant please state in what capacity.

Signature	
Date	
Capacity	

Contact name (where not previously given) and postal address for correspondence associated with this application (please read guidance note 13)

J & H LICENSING CONSULTANTS
35 WALFIELD AVENUE
WHETSTONE

Post town	LONDON	Post code	N20 9PS
Telephone number (if any)	0208 446 8643		
If you would prefer us to correspond with you by e-mail your e-mail address (optional) trev.jenny@btinternet.com			

Consent of individual to being specified as premises supervisor

HAYDAR GULTEKIN

I

[full name of prospective premises supervisor]

of

CHINGFORD

LONDON

[home address of prospective premises supervisor]

hereby confirm that I give my consent to be specified as the designated premises supervisor in relation to the application for

GRANT OF PREMISES LICENCE

[type of application]

by

NURCAN COSKUN

[name of applicant]

relating to a premises licence

[number of existing licence, if any]

for

295 HIGH ROAD

LOUGHTON

ESSEX

IG10 1AL

[name and address of premises to which the application relates]

and any premises licence to be granted or varied in respect of this application made by

NURCAN COSKUN

[name of applicant]

concerning the supply of alcohol at

295 HIGH ROAD

LOUGHTON

ESSEX

IG10 1AL

[name and address of premises to which application relates]

I also confirm that I am applying for, intend to apply for or currently hold a personal licence, details of which I set out below.

Personal licence number

[insert personal licence number, if any]

Personal licence issuing authority

WALTHAM FOREST COUNCIL, SYCAMORE HOUSE, WALTHAM FOREST
TOWN HALL, FOREST ROAD, WALTHAMSTOW, LONDON E17 4JF
0208 496 2247

[insert name and address and telephone number of personal licence issuing authority, if any]

Signed

Name (please print)

HAYDAR GULTEKIN

Date

23/5/13

GROUND FLOOR SHOP PREMISES

295 High Road
Loughton
Essex
IG10 1AL

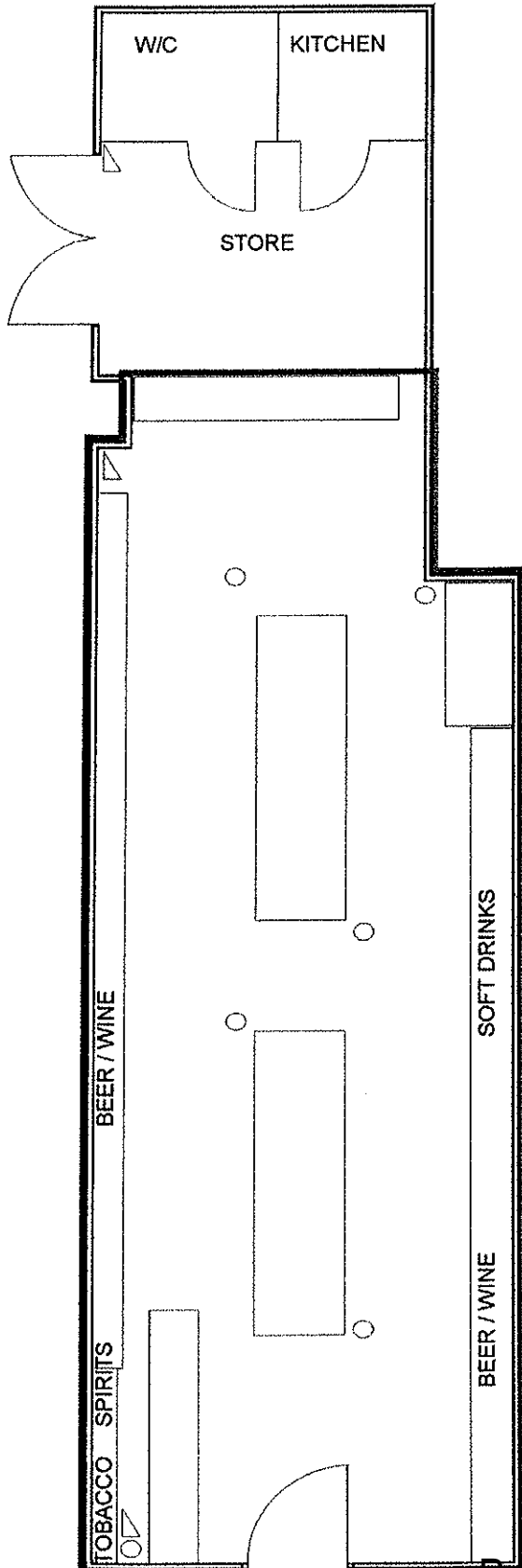

- ▲ FIRE EXTINGUISHER
- CCTV
- ALCOHOL SALES

Date:
May 2013

Scale:
1:100

Drawings by:
IMPERIAL PLANS
IMPERIAL COURT
1028 HIGH ROAD
LONDON N20 0QW

Rubbish Clearance

RUBBISH CLEARANCE
 • LOWEST PRICES
 • FREE ESTIMATES • RUBBISH REMOVED

020 8507 7390
 07957 123019

WE ARE RUBBISH
 Reliable 7 Day Service
 Cheapest Rates
 Call today on
 020 8523 9404
 07572 402101

Skip Hire

Hunt Skips
 Fast, reliable Service
 Excellent Rates
 020 8807 5948

TOWN SKIPS
 EXCELLENT SERVICE
 All Areas Covered
 076 8887 6867
 Townskips.co.uk

A & A SKIP HIRE
 All skips available
 Friendly, reliable service.
 Tel: 020 8529 6902
 07966 433791
 www.aastondonskiphire.com

Tiling Services

WALL/FLOOR TILING
 Kitchens, Bathrooms, Conservatories, Quality work reliable, tradesman, 020 8829 0253, 07890 473085

There's no substitute for experience
 Your local **Guardian**
 Established over 130 years
 To advertise telephone our display team on
0844 499 3118
 guardian-series.co.uk

Chatlines

336P CHEAP SEX
 LIVE XXX RELAX & PLAY
 0909 864 1063

GRANNY DOES IT REAL
36 FILTHY PHONE SEX
 0909 864 9712

Over **144,000** people could be looking at your advert online!
*source: Omniture Sept 2010

Find out how you can be seen on
guardian-series.co.uk
 020 8884 7425
 sales@london.newsquest.co.uk

Gardener's Plot

Fencing Services

ESSEX FENCING
 Top all your fencing needs
 Supply and install all types of fencing
 For a free quote call us on
 01621 799100 • 240245
 Office: 01621 799100
 240245 • essexfencing.com

Gardening Maintenance

Garden Service Ltd
 Garden Creators
 Patios, Decking, Brick walls, Turf
 Fences, Driveways, Tidy ups
 Call 020 3174 1619
 Or Freephone 0800 232 1877
 Or Paul on 07980 390 824
 www.gardenservice.co.uk

ALL OVERGROWN GARDENS
 Garden Clearance
 Turfing, Driveways, Fencing
 All types of maintenance
 FREE estimates
 All areas covered
 020 8508 7767
 07589 756898

M & D Home Improvements
 Patios • Fencing
 Turfing • Concrete
 Garden walls & sheds
 Jet Washing • Painting
 All repair work undertaken
 FREE ESTIMATES
 020 8485 9543
 07402 153677
 No deposit needed

Gardening Maintenance

TAYLOR TREE CARE
 All Types of Trees Expertly
 • Felled • Pruned • Shaped
 • Stumps Ground Out
 • Overgrown Gardens Cleared • Fencing
 Free Quotes

0208 485 9279
 07769 313 080

KV GARDENING SERVICES
 Ride on mowers to large gardens
 Fully licensed waste carrier
 Full Garden Maintenance Service
 Client References Available

Contact Beau 07947 807900
 After 6pm 020 8498 0592
 www.gardenservices.co.uk

BOWSON'S
 All tree & garden work undertaken
 Same Day Service
 30 years experience
 07572740919

GRASS CUTTING, hedge trimming & all garden work undertaken. Call 07779 563 214

Ads240
 www.guardian-series.co.uk

Let us help you put the pieces together

DESIGN PRINT DISTRIBUTION SALES

For all your leaflet needs call
 Tel: 01494 755109
 Fax: 01494 755165
 letterbox@london.newsquest.co.uk

LETTERBOX
 www.letterbox.co.uk

Public Notices

**LICENSING ACT 2003
 NOTICE OF APPLICATION FOR THE GRANT OF A PREMISES LICENCE**

Notice is hereby given that NURCAN COSKUN has applied to the Licensing Authority of Epping Forest District Council for the GRANT of a Premises Licence to permit THE SALE BY RETAIL OF ALCOHOL BETWEEN 07.00 AND 01.00 FOLLOWING EVERY DAY for the premises situated at 295 HIGH ROAD, LOUGHTON, ESSEX IG10 1AL. A register of licensing applications can be inspected during office hours at the Licensing Office of Epping Forest District Council, Civic Offices, High Street, Epping, Essex CM16 4EZ or www.eppingforestdc.gov.uk. Any person wishing to submit relevant representations concerning this application must give notice in writing to The Licensing Officer giving in detail the grounds of the representations no later than: 27th day of June 2013. Representations must relate to one or more of the four Licensing Objectives: the prevention of crime and disorder, public safety, the prevention of public nuisance and the protection of children from harm. It is an offence liable on conviction to a fine up to £5000 under section 158 of the Licensing Act 2003 knowingly or recklessly to make a false statement in connection with an application.
 Dated this 28th day of May 2013
 Signed J & H Licensing Consultants - Authorised Agents

Your local **Guardian**

firm





Licensing Department, Epping Police Station
230 High Street, Epping, CM16 4AP
Telephone 01279 625 405 Facsimile: 01279 625 440
Website: www.essex.police.uk Email: Peter.Jones@essex.pnn.police.uk

Mrs Kim Tuckey
Licensing Department
Epping Forest District Council
Civic Offices
High Street
Epping
CM16 4BZ

4 June 2013

Dear Kim,

LICENSING ACT 2003 – GRANT OF PREMISES LICENCE SECTION 17

NEW PREMISE: 295 High Road, Loughton

DPS: Haydar Gultekin

APPLICANT: Nurcan Coskun via J & H Licensing Consultants

Further to the above application for the Grant of a Premises Licence received on 29 May 2013, I write to inform you that Essex Police will be making representations for the following reasons:

The proposed premises are in a busy High Road with residential dwellings in close proximity, including above. It is also in close proximity to public houses with earlier closing times. As such, their patrons may continue to the proposed premises whilst already intoxicated. The noise that these and other customers can cause would be a disturbance to residents. Essex Police feel the proposed operating hours would cause an increase in Public Nuisance, and possible Crime and Disorder. For these reasons, Essex Police propose the hours should be amended to 0800-2300 Monday to Sunday.

Please advise me of when the Licensing Panel will be meeting to hear this so I can be in attendance.

Yours sincerely,

Mr Peter Jones ABII
Epping & Brentwood Licensing Officer
West LPA

Sarah Kits

From: Peter Jones <Peter.Jones@essex.pnn.police.uk>
Sent: 10 June 2013 13:15
To: Jenny Hughes
Cc: Sarah Kits
Subject: RE: Premises Licence Application - 295 High Road, Loughton [NOT PROTECTIVELY MARKED]
Attachments: 295 High Road, Loughton - Premises New - Representations.pdf

Dear All,

Apologies but due to illness last week, the actual objection letter was typed Tuesday, but didn't get sent. It is attached.

However, as a result of the email below confirming the applicants agreement to the amended licensable times, it is withdrawn.

Many Thanks

Peter Jones ABII (7706)

Epping & Brentwood Licensing Officer
West LPA

 Tel. 01279 625405 or 101 (Ext. 318175)

 Fax. 01279 625440 (Int. 318335)

 Peter.Jones@essex.pnn.police.uk

 www.essex.police.uk

 Epping Police Station
230 High Street
Epping
CM16 4AP

To find out what is happening in your neighbourhood and all about your local neighbourhood policing team visit www.essex.police.uk/yourarea and enter your postcode.

From: Jenny Hughes [mailto:trev.jenny@btinternet.com]
Sent: 06 June 2013 21:51
To: Peter Jones
Cc: skits@eppingforestdc.gov.uk
Subject: Re: Premises Licence Application - 295 High Road, Loughton [NOT PROTECTIVELY MARKED]
Importance: High

Mr Jones

Thank you for your reply.

We have taken further instructions from our client and can confirm that he is willing to amend his application to permit the sale of alcohol between 08.00 and 23.00 daily provided you withdraw any objection.

Jenny Hughes
J & H Licensing Consultants

Our Ref: L.1.1/VRM

Ms Sarah Kits
Licensing Section
Epping Forest District Council
Civic Offices
Epping
CM16 4BZ
(Emailed: skits@eppingforestdc.gcsx.gov.uk)

19 June 2013



LOUGHTON
TOWN COUNCIL

1 Buckingham Court, Rectory Lane
Loughton, Essex IG10 2QZ
Telephone: 020 8508 4200
Facsimile: 020 8508 4400
e-mail: contact@loughton-tc.gov.uk
Web site: www.loughton-tc.gov.uk
Town Clerk: Enid K Walsh

e-mail: vivienne.messenger@loughton-tc.gov.uk
ext 207

Dear Ms Kits

Re: Notice of application for a premises licence under the Licensing Act 2003 in respect of 295 High Road, Loughton IG10 1AL

Members present at the Planning and Licensing Committee meeting on 17 June 2013, made the following representation, as an interested party.

The Committee had NO OBJECTION to this licensing application provided the revised times for the sale of alcohol were from Monday to Sunday between the hours of 08.00 to 23.00 only. Curtailing the sale of alcohol to 11pm would be more likely to meet the four licensing objectives – the prevention of crime and disorder, public safety, the prevention of public nuisance, and protection of children from harm.

I would be grateful if you can acknowledge receipt of this letter and let me know whether it will go to the Licensing Sub-Committee or be dealt with by officers.

Yours sincerely

Vivienne Messenger
Planning Committee Clerk

The Licensing Team
Epping Forest District Council,
Civic Offices,
High Street,
Epping, Essex
CM16 4BZ

Mrs. C. Edwards
High Road
Loughton.
Essex.

20-6-13

To the Senior Licensing Officer

I understand that an application has been made by Mr Nurcan Coskun to sell alcohol between the hours of 7am – 1am at the premises underneath my home.

I strongly appeal this application;

The sale of alcohol between these hours will in turn increase anti-social behaviour very close to my home. We have an easily accessible car park behind our flats, which customers of this off license will use to park, congregate, drink, and make public nuisance.

I have a dog, which I walk early in the morning and late at night- I would not be able to do this, for fear of my safety- walking in and out of my building, where lighting and security is not present.

I have a young child, and would not be able to let him out in the near areas of my front door to play for fear of drunks or antisocial behaviour affecting him or endangering him.

There are also several young children and babies who live in the flats nearby- which I know would be directly affected by the noises of cars pulling up in our slip road to the front, and our car park to the back.

From experience at the other end of Loughton High road, I know that youths and groups of drunken people spilling out from the Nu Bar congregate outside Baileys Off Licence. This would be exactly the case outside our building, with people looking for after-hours drinks after they have been at Bar 15, The Last Post, The Olive Tree- any number of the premises already selling alcohol until the early hours in Loughton.

Please inform me of any new information regarding this application

Regards,

Sarah Kits

From: Tony GOREHAM <tony.goreham@uk.bnpparibas.com>
Sent: 10 June 2013 10:05
To: Licensing
Cc: tonygoreham@gmail.com
Subject: strongly oppose

Good morning,

As the owner of flat no [redacted] High rd Loughton, we strongly oppose the proposed ' application in respect of premises licenses', this would be totally unacceptable.

The majority of the above flats have families/children in them and allowing a late license or in fact any license to sell alcohol would be appalling.

I cannot think of much worse, there are already shops that are open late, Baileys, there is no need for another unless the council wishes increase the likely hood of aggravation for the local community and police force.

Regards Tony Goreham.

This e-mail may contain confidential and/or privileged information. If you are not the intended recipient (or have received this e-mail in error) please notify the sender immediately and delete this e-mail. Any unauthorised copying, disclosure or distribution of the material in this e-mail is prohibited.

Please refer to <http://www.bnpparibas.co.uk/en/email-disclaimer/> for additional disclosures.

Sarah Kits

From: Gregor Durston <Gregor.Durston@spacenk.com>
Sent: 20 June 2013 14:29
To: Licensing
Cc: Gregor Durston
Subject: Application WK/201314760

Dear Sirs,

Re: 295 High Road, Loughton IG10 1AL:

I refer to the above application for the above premises, the owners of which have applied for a licence allowing them to sell alcohol as part of their convenience store offer.

I wish to object to the granting of this licence on the following grounds.

1. Crime prevention: Space NK 291 High Road has experienced a number of costly break in attempts. The inclusion of a license to sell alcohol at the above location I feel with expose our premises to the possibility of increased criminal damage fuelled by alcohol.
2. Public nuisance: Noise and resulting disruption will be a by product of the sale of alcohol. This will be disruptive to the residents above and to our trade at certain times of the day.

Morrisons supermarket is opposite and sells alcohol. In addition there are numerous licensed premises within the immediate vicinity. I feel another licensed premises in unnecessary .

Regards,

Gregor Durston
Property Manager
Space NK Ltd

This email has been scanned by the Symantec Email Security.cloud service.
For more information please visit <http://www.symanteccloud.com>



Epping Forest District Council



Epping Forest District Council

Civic Offices
High Street
Epping CM16 4BZ

295 High Road Loughton

Centre X: 542419.000
Centre Y: 196479.000
Width : 225.000
Angle : .000

Scale : 1:1250	Date : 5 Jul 2013	Time : 09:49:45 AM
----------------	-------------------	--------------------

Contains Ordnance Survey & Royal Mail Data © Crown Copyright & Database Right 2012, EFDC License No: 100018534 2012 © Royal Mail Copyright & Database Right 2012, © Environment Agency, © Copyright Geo Perspectives, © Natural England 2012, Reproduced with the permission of Natural England



This page is intentionally left blank

Report to the Licensing Sub Committee



Date of meeting: 18 July 2013

**Epping Forest
District Council**

Subject: Sex Establishment Licence – Chase Farm, Vicarage Lane, West Epping

Responsible Officer: Kim Tuckey (01992 564034)

Democratic Services Officer: Gary Woodhall (01992 564034)

Decision Required:

- (1) To determine an application for a renewal of a Sex Shop licence.**

Report:

Application for Grant of Sex Establishment Licence

1. The District Council has received an application from Mr Ahmed of Spectrum North Weald Ltd for the grant of a renewal of a Sex Shop Licence in respect of the premises at Chase Farm Vicarage Lane West Epping Essex CM16 6AL.
2. The consultation period began on the 29/5/2013 and ended on 19/6/2013. A copy of the application is attached together with a copy of the public notice.
3. The authority did receive responses from Essex Police and Essex Fire Service, who stated that they also had no representations to make. No other objections were received.

Consultation

4. The 1982 Act requires the applicant for the grant of a Sex Establishment to:
 - (a) give public notice of the application by publishing an advertisement in a local newspaper and by displaying a notice on or near the premises for a period of 21 days; and
 - (b) send a copy of the application to the Chief Officer of Police.
5. In considering an application for the grant of a licence the Sub-committee must have regards to any observations submitted by the police and any validly submitted objections.
6. Any objections to the application must be in writing and received by the Council not later than 28 days after the date of application. Copies of any objections received are attached to this report.

Grounds for Refusal

7. The Act sets out the grounds upon which an application for the grant of a licence **must** be refused and upon which a grant application **may** be refused.

8. A licence **must** not be granted:
- (a) to a person under 18;
 - (b) to a person who has been disqualified from holding a licence;
 - (c) to a person not a resident of the United Kingdom or was not so resident throughout the period of six months immediately preceding the application;
 - (d) to a Company not incorporated in the United Kingdom; or
 - (e) to a person who has been refused a licence within the last 12 months a person who has, within a period of 12 months immediately preceding the date when the application was made, been refused the grant or renewal of a licence for the premises, vehicle, vessel or stall in respect of which the application is made, unless the refusal has been reversed on appeal..
9. An application for the grant of a licence **may** be refused on the following grounds:
- (a) that the applicant is unsuitable to hold the licence by reason of having been convicted of an offence or for any other reason;
 - (b) that if the licence were to be granted, renewed or transferred, the business to which it relates would be managed by or carried on for the benefit of a person, other than the applicant, who would be refused the grant, renewal or transfer of such a licence if he made the application himself;
 - (c) that the number of sex establishments in the relevant locality at the time the application is made is equal to or exceeds the number which the authority consider is appropriate for that locality;
 - (d) that the grant or renewal of the licence would be inappropriate, having regard:
 - (i) to the character of the relevant locality;
 - (ii) to the use to which any premises in the vicinity are put;
 - (iii) to the layout, character or condition of the premises, vehicle, vessel or stall in respect of which the application is made.
10. The Act specifically provides that for the purposes of (c) above **nil** may be an appropriate number.

Relevant Locality

11. In relation to grounds (c) and (d) above, the Act defines the “relevant locality” as the locality where the premises are situated. The Authority’s policy provides that there is a general presumption against the granting of licences for premises which are:
- Adjacent to, or in the vicinity of places of worship;
 - Adjacent to, or in the vicinity of schools, nurseries or other educational establishments;
 - Adjacent to, or in the vicinity of public buildings or community facilities;

- Adjacent to, or in the vicinity of family residential areas;
- Adjacent to, or in the vicinity of a family leisure or shopping areas;
- Adjacent to, or in the vicinity of public buildings or community facilities;
- In an area earmarked for regeneration of a particular kind;

and access routes to and from the same.

Comments on the Application

12. Insofar as officers are aware, none of the mandatory grounds for refusal set out in paragraph 8 above are applicable in respect of this application.

Conditions

13. The Act provides that the licence shall remain in force for one year or such shorter period as the authority may decide unless previously or cancelled or revoked.

14. The Council can impose terms and conditions and impose restrictions on the licence.

Appeals

15. If the application is refused based upon the discretionary grounds 12 (3) (a) and (b) of The Act (set out in paragraph 8 (a) and (b) of this report) the applicant may appeal within 21 days to the Magistrates Court.

15. The Act provides for no appeal against refusals under grounds 12 (3) (c) and (d) of the Act (set out in paragraph 8 (c) and (d) of the report) although decisions under these grounds have been challenged in the Courts by way of judicial review on the ground that the decision was not properly taken or that there was some procedural irregularity or breach of the rules of natural justice.

16. If members decide to refuse the application they shall, if required to do so by the applicant, give her a statement in writing of the reasons for the decision within 7 days of the request to do so.

Resource Implications:

None.

Legal and Governance Implications:

Local Government (Miscellaneous Provisions) Act 1982.

Safer, Cleaner and Greener Implications:

None.

Consultation Undertaken:

Statutory consultation undertaken, the results have been set out above.

Background Papers:

- Epping Forest's Sexual Entertainment Venue and Sex Establishment Licensing Policy
- (Home Office Guidance - Sexual Entertainments Venues)

Attached Documents

- Application for grant of a renewal of an existing licence for a sex shop establishment.
- Public Notice
- Representations received



Epping Forest District Council

Epping Forest District Council
Application for grant/renewal/transfer
of licence for a sex establishment

If application is made on behalf of an individual please state:

Full name: MR. SHAZAD AHMED

Permanent address: CRANBOURNE AVE. LONDON E11

Age: Date of Birth: Place of Birth: NEW HAVY

If application is made on behalf of a corporate or unincorporated body please state:

Full name of body: SPECTRUM (NORTH WEALD) LTD UNIT 119

Address of registered or principal office: CHASE FARM, NICKRAGE LANE WEST, NORTH WEALD, EPPING, ESSEX CM16 6AL

Give full names and private addresses of all directors or other persons responsible for management of the establishment:

Name: MR. GHAFUR AHMED

Age: Date of Birth: Place of Birth: PAKISTAN

Address: CRANBOURNE AVENUE LONDON

Name: MR. SHAZAD AHMED

Age: Date of Birth: Place of Birth: LONDON

Address: CRANBOURNE AVENUE LONDON

Name: MRS. MANIQA AHMED

Age: Date of Birth: Place of Birth: PAKISTAN

Address: CRANBOURNE AVENUE LONDON E11

Name:

Age: Date of Birth: Place of Birth:

Address:

Name:

Age: Date of Birth: Place of Birth:

Address:

Have you any conviction record against you? Or if a body corporate or unincorporated body that body or any of its directors or other persons responsible for its management? If so please state -

(If renewal, since you last applied for a licence)

Date of Conviction Offence Sentence (including suspended sentence)

N/A

- (a) All convictions must be disclosed
(b) Spent convictions, as defined below, should not be included.

Sentence:	Becomes spent after:
Imprisonment of between 6 months and 2½ years:	10 years
Imprisonment of up to 6 months:	7 years
Borstal training:	7 years
A fine or other sentence not otherwise covered in this table:	5 years
Absolute discharge:	6 months
Probation order, conditional discharge or bind over:	1 year (or until order expires, whichever is the longer)
Detention Centre Order:	3 years
Remand home, attendance centre or approved school order:	The period of the order and a further year after the order expires
Hospital order under the Mental Health Act:	The period of the order and a further 2 years after it expires
Cashiering, discharge with ignominy or dismissal with Disgrace from the Armed Forces:	10 years
Dismissal from Armed Forces:	7 years
Detention:	5 years

N/A

- NOTE: (i) A sentence of more than 2½ years imprisonment can never Become spent.
(ii) If you were under 17 years of age on the date of conviction, please halve the period shown in the right-hand column.

Have you been resident in the United Kingdom throughout a period of six months immediately preceding the date of this application? YES/~~NO~~

If the application is made on behalf of a body corporate is that body incorporated in the United Kingdom? YES/~~NO~~

Full address of premises desired to be used as a sex establishment
UNIT 11 G CHASE FARM VICARAGE LANE WEST EPPING CM16 6AL

If this application relates to a vehicle/vessel/stall give description and state where it is to be used as a sex establishment

N/A

During which hours do you wish to trade?

10AM TO 6PM MONDAY TO FRIDAY

Are the premises to be used as a sex shop? YES/~~NO~~

Are the premises to be used as a sex cinema? ~~YES~~/NO

Are the premises to be used as a sex encounter establishment? YES/NO

Are you (or, if a corporate or unincorporated body, that body) disqualified from holding a licence for a sex establishment? YES/NO

Have you ever been refused a licence for a sex establishment? ~~YES~~/NO

If yes please give details

I declare that I have checked the information given on this application form and to the best of my knowledge and belief it is correct.

Date 29/05/2013 Signature 

Publication of notice of application for a licence

Epping Forest District Council

Licensing of sex establishments

Address of premises UNIT 11 G CHASE FARM VICARAGE LANE WEST

Name of proposed licensee SPECTRUM (NORTH WEALD) LTD

Signed [REDACTED] Date 29/5/2013

*Describe the part of the premises or other nearby location upon which the notice was affixed.

NOTICE AFFIXED OUTSIDE
UNIT 11

★ All mechanical work undertaken
 ★ Crash repairs
 ★ Courtesy car available
 ★ Electrical repairs
 ★ Recovery service
 (Reduced rates for OAPs and Civil Services)

YOU NAME IT - WE DO IT!

Abbey Motorists Centre

01992 701201

51 Cartersfield Road
 Waltham Abbey
 (Behind Nissan Garage
 off Sewardstone Road)

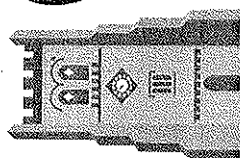

Public Notices

EPPING FOREST DISTRICT COUNCIL
 Licensing of sex establishments
 Public Notice

Application under the provision of the Local Government (Miscellaneous Provisions) Act, 1982
 Notice is hereby given that we SPECTRUM (NORTH WEALD) LTD applied on (Date) to Epping Forest District Council in respect of the premises known as UNIT 11G CHASE FARM VICARAGE LANE WEST NORTH WEALD EPPING ESSEX CM36 6AL for a licence to use the premises as a "SEX SHOP". ANY PERSON wishing to make representation about the application should make them in writing to the Epping Forest District Council, Corporate Services, High Street Epping Essex CM16 4BZ, on or before (Date). Letters in support should also be sent to the Director of Corporate Support Services by that date. Please note that any written representations received in response to this consultation are likely to be required to be made available for public inspection in accordance with the Local Government (Access to Information) Act 1985.

Goods Vehicle Operator's Licence

Kings Logistics Ltd of Hanger 5, North Weald Airfield, Essex CM16 6HR is applying for a licence to use Hanger 5, North Weald Airfield, Essex CM16 6HR as an operating centre for 4 goods vehicles and 4 trailers. Owners or occupiers of land (including buildings) near the operating centre who believe that their use or enjoyment of that land would be affected, should make written representations to the Traffic Commissioner at Hillcrest House, 386 Harshills Lane, Leeds LS9 6NF stating their reasons, within 21 days of this notice. Representations must at the same time send a copy of their representations to the applicant at the address given at the top of this notice. A guide to making representations is available from the Traffic Commissioner's Office.

your
 business
 online
 for more
 information
 visit:
www.guardian-series.co.uk
TODAY!
Guardian

Public Notices

Application for a Premises Licence under the Licensing Act 2003

Notice is given this day the 31st May 2013, that The Green Owl Limited of c/o Cohen Arnold, New Burlington House, 1075 Finchley Road, London NW11 0PU has applied to the Licensing Office of Epping Forest District Council for a Premises Licence in respect of: Ground Floor Shop and Premises, 44 Queens Road, Suckburt Hill, Essex IG9 5BY. The proposed licence is for: Recorded Music (F) Monday to Sunday inclusive 0800 - 2330; Supply of Alcohol (M) Monday to Sunday inclusive 0800 - 2300; the opening hours of the premises (O) Monday to Sunday inclusive 0800 - 2330. The register of licensed premises is maintained at the Licensing Office of Epping Forest District Council, Civic Offices, High Street, Epping, Essex, CM16 4BZ. Applications for premises licences may be inspected at this office during office hours. Anyone wishing to oppose this application must give written notice to the Licensing Office within 28 days of this notice. It is an offence knowingly or recklessly to make a false statement in connection with an application which could lead to a fine on summary conviction (maximum £5,000).

(Bournebridge Lane, Stapleford Abbotts) (Temporary Prohibition of Traffic) Order 2013

Notice is hereby given that the Essex County Council has made the above Order under section 14(1) of the Road Traffic Regulation Act 1984.
Effect of the order: To temporarily close that length of Bournebridge Lane in the parish of Stapleford Abbotts in the District of Epping Forest from a point 1300 metres west of its junction with B175 Stapleford Road north-west for a distance of 150 metres.
 The closure is scheduled to commence on 12 June 2013 for 1 day between the hours of 9.30am and 3.30pm or where appropriate signs are showing and weather permitting.
 The closure is required for the safety of the public and workforce while BT undertake works to replace a pole and cable.
 The alternative route will be via Stapleford Road, Hook Lane and vice versa.
 Access for emergency service vehicles and pedestrians will be maintained at all times during the closure.
 The Order will come into effect on 12 June 2013 and may continue in force for 18 months or until the works have been completed, whichever is the earlier.

(Various Roads, Epping Forest & Uttlesford) (Temporary Prohibition of Traffic) Order 2013

Notice is hereby given that the Essex County Council intends, not less than seven days from the date of this notice, to make the above Order under section 14(1) of the Road Traffic Regulation Act 1984.

Effect of the order: To temporarily close the various lengths of roads in the Districts of Epping Forest and Uttlesford as specified:

Road	Description	Alternative Route
Shows Farm Lane, White Roding and Abbess Beauchamp & Berners Roding	From its junction with Matchings Lane (also known as Waterloo Farmhouse Lane) southwards to its junction with Anchor Lane.	Anchor Lane, Potash Road, Watery Lane, Downhall Road, Matching Road, The Heath, A1060 Storrford Road, Church Lane, Waterloo Road and vice-versa
Bridge End, Newport	From its junction with B1383 Belmont Hill southwards to its junction with B1383 Cambridge Road.	No alternative route but access to properties will be maintained.
Dellows Lane, Ugley	From its junction with Bedwell Road south-westwards then northwards for its entire length.	No alternative route but access to properties will be maintained.

The closures are scheduled to commence within 18 months from 14 June 2013 or where appropriate signs are showing and weather permitting, and are required for the safety of the public and workforce while highway maintenance works are undertaken. Exact dates of the road closures will be notified via advanced warning signage on sites. Letters to residents and other affected or interested parties advising of the works/dates and other relevant information will also be sent out at least 2 weeks in advance.
 Access for emergency service vehicles and pedestrians will be maintained at all times during the closure.

The Order will come into effect on 14 June 2013 and may continue in force for 18 months or until the works have been completed, whichever is the earlier.
Liz Saville, Head of Network Management, County Hall, Chelmsford.
 Dated: 6 June 2013

Essex County Fire & Rescue Service

Mr David Johnson LL.B(Hons), BSc, MA, MSc, FCFI
Chief Fire Officer & Chief Executive



N Clark
Licensing Department
Epping Forest District Council,
Civic Offices, High Street,
EPPING,
Essex. CM16 4BZ

WEST AREA COMMAND
Harlow Service Delivery Point
Fourth Avenue
HARLOW
CM20 1DU
☎ 01279 420841
✉ he.command@essex-fire.gov.uk

Date: 31st May 2013
Our Ref: CG/TG/FP/89/2262/1
Your Ref:
Enquiries to: Sub Officer Chris Gilham
Work Place Fire Safety Officer

Dear Sir/Madam

LICENSING ACT 2003 THE REGULATORY REFORM (FIRE SAFETY) ORDER 2005

Type of Licence: Licence for a Sex Establishment.

Premises: Spectrum, Chase Farm, Unit 11G, Vicarage Lane, North Weald, Essex. CM16 6AL

Receipt is acknowledged of the above consultation(s), which will be audited by the Essex Fire Authority (The Authority).

Should there be any significant concerns regarding the application(s) you will be notified in due course.

Yours faithfully

A large black rectangular redaction covering the signature area of the letter.

Chris Gilham
Fire Safety Officer



Licensing Department, Epping Police Station
230 High Street, Epping, CM16 4AP
Telephone 01279 625 405 Facsimile: 01279 625 440
Website: www.essex.police.uk Email: Peter.Jones@essex.pnn.police.uk

Mrs Kim Tuckey
Licensing Department
Epping Forest District Council
Civic Offices
High Street
Epping
CM16 4BZ

29 May 2013

Dear Kim,

**LOCAL GOVERNMENT (MISCELLANEOUS PROVISIONS) ACT 1982
– SEX ESTABLISHMENTS RENEWAL –**

ESTABLISHMENT: Spectrum (North Weald) Ltd

Further to the above application for the renewal of a Sex Establishments Licence received on 29 May 2013. I can now confirm that all my checks have been carried out and can confirm that Essex Police will not be making any representations or objections to this application.

I trust the aforementioned will assist and look forward to receiving a copy of the Licence in due course.

Yours sincerely,

Mr Peter Jones ABII
Epping & Brentwood Licensing Officer
West LPA



**Epping Forest
District Council**

Local Government (Miscellaneous Provisions) Act 1982

Sex Establishment Licence

Epping Forest District Council, hereby grant a licence under Schedule 3 of the above Act to Spectrum North Weald Limited of Unit 11G Chase Farm, Vicarage Lane North Weald Essex to use the ground floor premises situated at Unit 11G Chase Farm, North Weald Essex for the purposes of a sex establishment comprising a **sex shop** as defined in that schedule.

This licence is granted subject to the conditions set out below.

This licence shall continue in force from the 5th June 2012 until the 4th June 2013 unless revoked.

Date: 7TH August 2012

Corporate Support Services

Conditions

LOCAL GOVERNMENT (MISCELLANEOUS PROVISIONS) ACT 1982 AS AMENDED BY THE POLICE AND CRIME ACT 2009

Enquiries to:

PART 1

Standard Conditions for all Sex Establishments

Management of the Premises

1. The Licensee or some responsible person nominated by him over the age of 18 and approved in writing by the Council for the purpose of managing the sex establishment ("the manager") shall have personal responsibility for and be present on the Premises at all times when the Premises are open to the public.
2. Where the Licensee is a body corporate or an incorporated body, any change of director, company secretary or other person responsible for the management of the body shall be notified in writing to the Council within 14 days of such change and such written details as the licensing authority may require in respect of the change of personnel shall be furnished within 14 days of a request in writing from the Council.
3. The name of the person responsible for the management of the Premises, whether the Licensee or the manager, shall be displayed in a conspicuous position within the Premises throughout the period during which he is responsible for the conduct of the Premises.
4. The Licensee shall retain control over all parts of the Premises and shall not let, licence or part with possession of any part. The Council must be immediately notified in the event that any part of the Premises is affected by the termination of a lease or other event affecting the Licensee's control of the Premises.
5. The Licensee shall ensure that the public is not admitted to any part of the Premises that has not been licensed.
6. Neither the Licensee nor any employee or agent shall personally solicit custom for the sex establishment outside or in the vicinity of the Premises.
7. The Licensee shall ensure that during the hours that the Premises are open for business every employee wears a badge of a type approved by the Council indicating his name and that he is an employee. This shall not apply to any Performers.

Display of Licence

8. A copy of the Sex Establishment Licence and the Conditions of the Licence made by the authority must be kept exhibited in the public area of the premises.

Age Policy

9. No person under 18 years of age to enter the premises.
10. All customers appearing to be under the age of 25 to be required to provide photographic proof of their age before being allowed access to the shop.
11. No person under 18 years of age is to be employed in the business establishment.
12. At all entrances there shall be prominently displayed so as to be visible at all times to persons approaching the premises a notice prohibiting entry to all persons under 18 years of age.
13. The Licensee of the premises shall ensure that all persons employed on the premises are aware of the age restriction on clients and that they exclude or remove from the premises any person attempting to evade the restriction.
14. No change from a sex cinema to a sex shop or a sex shop to a sex cinema shall be made without the written consent of the Council.

Civic Offices High Street
Epping Essex CM16 4BZ

Telephone: 01992 564000
Facsimile: 01992 578018
DX: 40409 Epping

Director of Corporate Support
Services Colleen Boyle
Epping Forest District Council

Enquiries to:

Breach of Licensing Conditions

15. Any breach of legislation or failure to comply with the conditions attached to the Licence may result in prosecution or in the revocation of the Licence.

General

16. The Council may substitute, delete, vary or amend these conditions at any time.

PART 2

STANDARD CONDITIONS FOR SEX SHOPS

Corporate Support Services

Opening of the Premises

1. The Premises shall not, without the written consent of the Council, be opened and used for the purposes for which the licence is granted except during the following hours unless the Council agrees otherwise:

Monday – Saturday 9 am – 6 pm
Sunday - Closed

Civic Offices High Street
Epping Essex CM16 4BZ

Telephone 0192 564000
Facsimile 0192 578018
DX: 40409 Epping

Director of Corporate Support
Services Colleen O'Boyle
Solicitor to the Council

2. The Premises shall not, without the written consent of the Council, be opened and used for the purposes for which the licence is granted on Christmas Day or Good Friday.

Enquiries to:

External Appearance

3. Except for the sign specified in condition 12 – Part 1 Standard Conditions for all Sex Establishments (Age Policy) no other information, display, advertisement or notice shall be exhibited in any position visible to passers by without the written approval of the Council.
4. No external loudspeakers may be installed.
5. The windows, doors and openings of the Premises shall be of a material or covered with a material, which will render the interior of the Premises invisible to passers-by.

State, Condition and Layout of the Premises

6. External doors shall be closed at all times other than when persons are entering or leaving the Premises. The external doors shall be fitted with a device to for their automatic closure and such devices shall be maintained in good working order.
7. The Premises shall be fitted with an inner entrance door or screen so that no part of the interior of the Premises or any of the contents of the Premises shall be visible when persons are entering or leaving the Premises.
8. No access shall be permitted through the Premises to any other Premises adjoining or adjacent except in the case of emergency.
9. Lighting shall be in operation continuously during the whole of the time that the Sex Establishment is open to the public.
10. Any facilities for previewing films, video recordings or other similar material shall be physically separated from the display area of the shop in such a manner that no material being displayed by way of preview shall be visible or audible outside the preview area.
11. No locks or fastenings of any description shall be fitted upon any booth or cubicle within the Sex Establishment nor shall more than one person (including any employee) be present in any such booth or cubicle at any time.

Safety and Security

12. The Licensee shall ensure a suitable closed-circuit television system is installed and

maintained to the satisfaction of the Council and police compliant with the codes of practices issued under the Data Protection Act 1998.

Goods Available in Sex Establishments

13. All Sex Articles as defined in Schedule 3 to the Local Government (Miscellaneous Provisions) Act 1982 and other things displayed for sale, hire, exchange or loan within a Sex Establishment shall be clearly marked to show to persons who are inside the Sex Shop the respective prices being charged.
14. All printed matter, films and video films offered for sale, hire, exchange or loan shall be openly displayed and available for inspection prior to purchase and a notice to this effect is to be prominently displayed inside the Sex Establishment. This regulation does not require that films or video films be exhibited (played) to customers.

Civic Offices, High Street
Epping, Essex CM16 4BZ
Telephone: 01992 564000
Facsimile: 01992 578018
DX: 40409 Epping

Director of Corporate Support
Services, C. J. Boyle
Council Offices
Enquiries to:

This page is intentionally left blank